

Jinny Blom



Entitled 'A Moment of Reflection', Jinny's third garden for Chelsea takes the 'journey of life' as its inspiration with naturalistic planting and handcrafted details in a warm peaceful setting. SPONSOR: Laurent-Perrier

SYMBOLISING THE UNPREDICTABLE JOURNEY we all take through life, a series of pathways on various levels invite visitors to take different routes around the garden. Made of travertine marble set on concrete plinths, the paths flow through the planting rather than the other way around. Jinny's design reveals the detailing of the hard landscaping (including the fixings, braces and back stays), all of which are beautifully crafted. "In the spirit of Italian architect Carlo Scarpa, I wanted to show how beautiful materials can combine with functionality," says Jinny. The overall impression is one of integrity, tranquillity and beauty. At the garden's entrance a bronze sculptural 'moon gate' represents the beginning of life, and is echoed at the far end of the garden by a complex, floating lunar gate suspended above a dark pond with stepping stones symbolising the transition through life's challenges. The lunar gate frames a dramatic red sandstone disk, which forms the backdrop to a seating area that invites contemplation and relaxation. The fragility of the garden is balanced by clipped hornbeam hedging. "I love the fact that it all looks so simple, but it really isn't," says Jinny.

LOOK OUT FOR

- **STYLE/COLOURS:** Burgundy, claret and soft pinks are shot through with lime green and flashes of orange (see right).
- **PLANTS:** *Astrantia*, *Anthriscus sylvestris* 'Ravenswing', *Quercus robusta* f. *fastigiata* 'Koster', hornbeam, iris, *Tulipa acuminata*.
- **CONTACT:** 020 7253 2100, www.jinnyblom.com
- **PLOT:** MA 17 (Main Avenue)

"I was inspired by life in all its wonderful diversity – how we live through difficult and good times. I thought let's celebrate it and all things wonderful in the garden"

Jinny Blom

INSPIRATION

The hard landscaping of Jinny's garden is based on her fascination with Italian architect Carlo Scarpa (1906-1978), who had a profound interest in materials. To create a warm, peaceful setting Jinny has used a lush, naturalistic floral palette (see below).

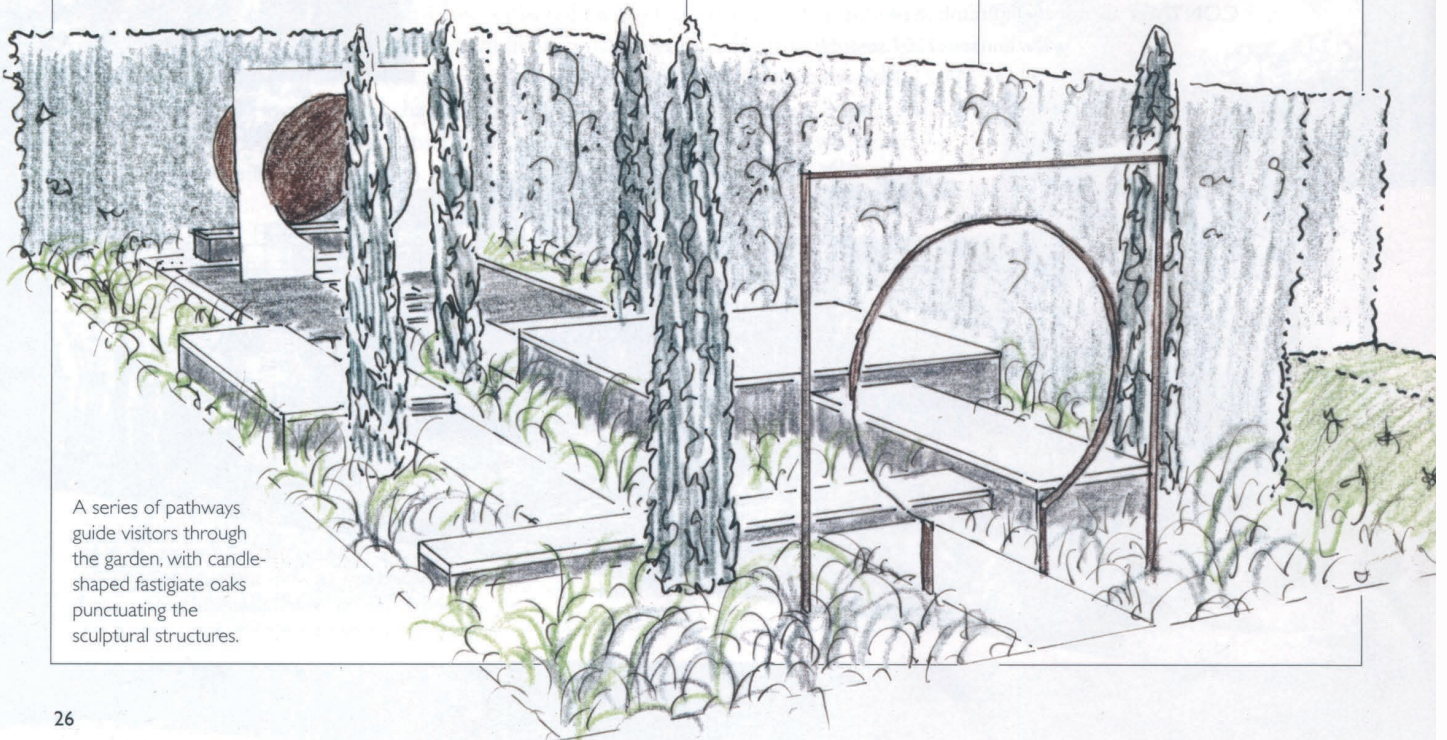

A series of pathways guide visitors through the garden, with candle-shaped fastigiate oaks punctuating the sculptural structures.